

MFC STORAGES



■ **Code:** FTA 1007 045

■ **Description:** MFC structure, without doors, with doors, with tambour doors, drawers and/or pulling drawers

ACTIU STORAGE

EASY ACCESSIBILITY



■ **MFC STORAGES GENERAL FEATURES**

MFC STORAGES GENERAL FEATURES		
STRUCTURAL FEATURES	Material	Chip wood board divided in three layers, particle board with pressed synthetic resins in hot temperature. Sanding. Density 630 Kg/m³. Covered with mfc decorative paper. (Different thicknesses:10, 16, 19, 25 and 30 mm)
	Frame	Easy to assembling and dismantled. (Exposed or standard back)
	Side Panels	MFC 19 mm thickness and 650 Kg/m³ density
	Base	Base without obstacles
	Linking devices	Intuitive and easy assembling system. Clipping, hooking and screwing systems by using eccentric fittings with steel bolts
	Shelves	MFC 25 mm thickness and 630 Kg/m³ density
	Suspension files Optional	Optional steel metal shelves 0,8 mm thickness, double lower runner for suspension files
	Height adjustable shelves	Easy to adjust. Height points every 32 mm
	Capacity	Easy access spaces. Optimum capacity for DIN A4 folders
COMPLEMENTARY FEATURES	Handles	Ergonomics.Zamak moulded products (zinc, aluminium, magnesium and copper alloy) silver finish
	Lock	Lock with two positions. Open and close. Unique key. Top security
	Leveller	4 levelers. Inner easy access +20 mm. Perfectly lined up
	Assembling time	6-8 min. (two people)
TECHNICAL DETAILS	Scratches resistance (UNE EN 14323)	≥ 1,5 N
	Spot resistance (UNE EN 14323)	≥ Grade 3. Non visible defects
	Exhaustion resistance (UNE EN 14323)	≥ Grade 3. Resistant
	Surface aspect (UNE EN 14323)	Silk texture, mate finish. Grade 4
	Edges damages (UNE EN 14323)	≤ 10 mm/m
	Points fault (UNE EN 14323)	≤ 2 mm²/m²
	Scratches faulty (UNE EN 14323)	≤ 20 mm²/m²
	Covering	Decorative paper covered by resistant melamine, specially for horizontal applications. Non fingerprints
	Covering thickness (UNE EN 14323)	Standard thickness = 120 gr. Perfect product to be used in surfaces with a constant use
	Resistance to aggressive home cleaning products without solvent (UNE EN 14323)	Good resistance to acids, alcalys and room temperature oils
	Resistance to spots (UNE 14323)	Without visible defects
	Maintenance	Easy to clean. Use PH neutral products



■ FEATURES

- 1 Top MFC 25 mm thickness
- 2 Shelves MFC 25 mm thickness or steel metal shelves 0,8 mm thickness, double lower runner for suspension files
- 3 Side Panels MFC 19 mm thickness
- 4 5 mm MDF back panel 16 mm matching back panel for corridors **(Optional)**
- 5 Dismantling frame
- 6 Open-close position locker
- 7 Optimum capacity for DIN A4 folders
- 8 Handles. Zamak moulded products Silver finish
- 9 Height adjustable shelves, different positions every 32 mm
- 10 Anti humidity with levellers
- 11 4 levelers. Inner easy access
- 12 Obstacle free
- Storages with doors:
 - 13 Hinges with automatic lock on system. Three positions. Self-locking door. Opening 110°.
 - 14 **(Optional)** silent system hinges to close the doors gently
 - 15 Locking system with longitudinal flat side latches
 - 16 Hinged doors manufactured by mfc 16mm or aluminium frame with 4 mm thickness glass
- Storages with drawers and/or with filing drawer:
 - 17 Steel telescopic balls bearing slides. Maximum length. Pre-galvanized, layer passivization, electrolytic to salt resistance
 - 18 Front drawers and filing drawers manufactured in: Steel 0,8 mm thickness or melamine 16 mm thicknesses
 - 19 Steel drawers and filing drawer bottom 0,8 mm thickness
 - 20 Lock with anti tilt mechanism

■ FINISHES

MELAMINE (MFC) - 1 COLOUR



White Lime Oak Walnut-N Chestnut Wengue Dark Oak

(see finishes card)

MELAMINE (MFC) - 2 COLOURS



Silver/White Silver/Maple Silver/Light oak Silver/Elm Silver/Walnut-N Silver/Chestnut

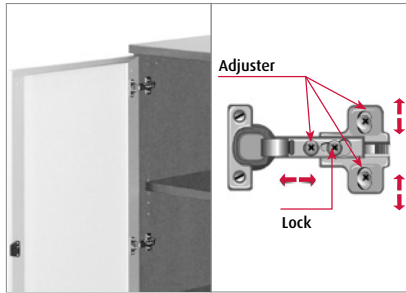

Doors and hinges



Shelves



Height adjustable shelves

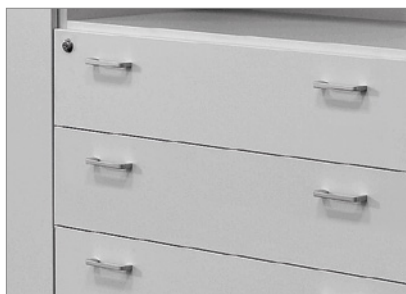

Drawers



Filing drawer



Pull out frame



Anti humidity polystyrene foot

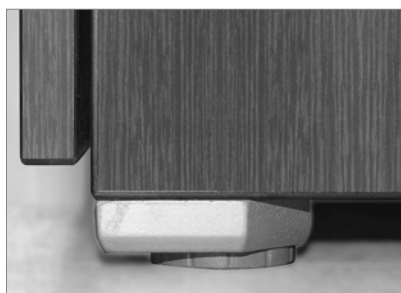

Levellers

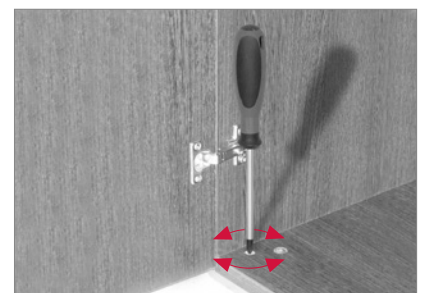

Levelling adjustment

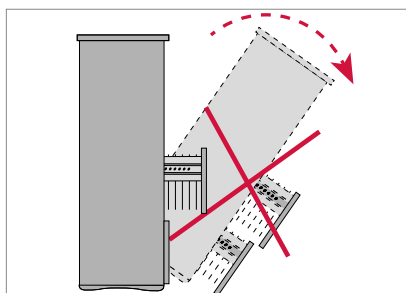

Anti tilt mechanism

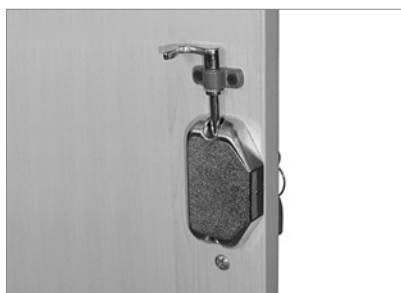

Locking bar



Aluminium Handle

76,04% recycled materials

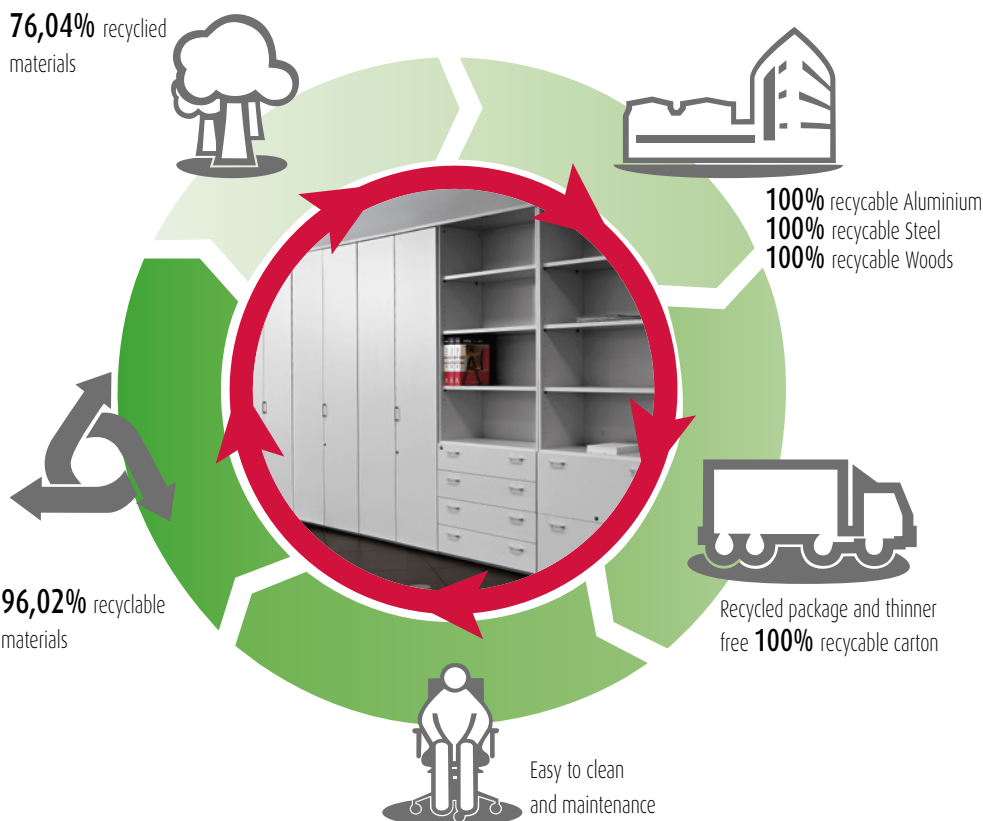

MATERIALS

MFC STORAGES has been designed to be manufactured with recycled materials 76,04%, danger substances such as chrome, mercury or cadmio are not used in big quantity. Recyclable Aluminium, Steel or Woods 100%. Organic volatile Components. Packages manufactured with recycled carton. Ink thinner free.



PRODUCTION

Energy use is optimized during the production process. Minimum environmental impact. Last generation technological system in coating processes. Painting that have not been used is recovered to use it again. Zero COVs emissions and other contaminant gas. Close water circuit to clean the metals. Heat recovery. Automatic manufacture systems. Cut process is planned.



TRANSPORT

Optimum packaging to reduce space in transport and save energy.



USE

Long lasting use. Spare parts and replacements available. Easy to clean and maintenance.



DISPOSAL

96,02% recyclable. Easy and quick to split **MFC STORAGES** components. Packages are reuse by our supplier to avoid waste generation. Carton used in packages is recyclable.

CERTIFICATES AND REFERENCES

The different programmes get points in different environmental categories to get the LEED certificate (sustainability, material and resources, water, energy and atmosphere, inner environment quality, innovation and design).



The mark of responsible forestry



PEFC Certificate



EN ISO 14006:2011
ECODESIGN Certificate



UNE-EN ISO 9001:2008
ISO 9001 Certificate



UNE-EN ISO 14001:2004
ISO 14001 Certificate



E1 by EN 13986 Certificate



ACTIU TECHNOLOGICAL PARK
project certified as **LEED® GOLD**
by U.S. Green Building Council 2011
Leadership in Energy & Environmental Design

■ STANDARDS

MFC STORAGES have passed all test done in our technological laboratory as well as the essays done in **(AIDIMA)** Furniture Technological Institute:

UNE EN ISO 14073. Office Furniture. Furniture Storage.

- **UNE-CEN/TR 14073-1:2005 IN.** Office Furniture. Furniture Storage. Part 1: Dimensions.

- **UNE-EN 14073-2:2005.** Office Furniture. Archive furniture. Part 2: Mechanical security requirements.

■ ACCESSIBILITY

Comfortable and Open. We design furniture to solve all needs at any moment and perfectly integrated in any nowadays working spaces: more agile and comfortable, efficient and multipurpose.

These modules split working spaces providing confidentiality and privacy. An easy filing and storing solution for daily accessibility.

■ STRONG

Stable and Solid. Resistant furniture. Precisse finishes with delicate details. To get this, we have the most avant garde technology.

Storages have double panel sides to provide more stability, solidity and resistance and guarantee the lasting of the product.

■ ECOLOGY

ENERGY SAVING

The new technological production system included, reduce the energy resources used to manufacture each component. Materials are very well used to avoid wastes.

RECYCLED AND RECYCABLE MATERIALS

ACTIU environmental policy opts to use recycled materials in those components where functionality and lasting is not a condition. Materials used in MFC STORAGES such as Aluminium and Steel sare totally recyclable.

SUSTAINABLE CERTIFICATE

ACTIU has **PEFC y FSC**, certificate to proof that the wood used in our products comes from sustainable exploitations and **ECODESIGN ISO 14006** certificate.

■ REMARKABLE VALUES

1 - ACTIU has **PEFC y FSC**, certificate to proof that the wood used in our products comes from sustainable exploitations and **ECODESIGN ISO 14006** certificate.

2 - MFC boards used in Melamine Pedestal fulfill **CLASS E1** , low content of formaldehyde as per Standard **UNE-EN 14322**.

3 - Chip board covered by pressure n and temperature with melamine paper to create wood texture. Paper is perfectly fixed to the board as well as a perfect surface finish, resistance without any further treatments.